



THE TRILLIUM COLLECTION

Thistlewood Timber Frame Homes



Plan Number: BAY-01-2006

The Bayfield

By *Thistlewood*[®]
Timber Frame Homes

Enjoy the style and luxury of this hybrid timber frame home while enjoying the savings of the combination of timber frame with conventional construction.

This home offers a great layout with open concept living, an optional loft area or bedroom and cathedral ceilings which showcase the stunning timber frame elements of the home.



Package Includes:

- ✓ Standard house construction plans.
- ✓ Partial timber frame structure. (assembly required)
- ✓ Stressskin Insulated Panels (SIPs) form all exterior walls and timber frame roof areas.
- ✓ Engineered trusses and plywood sheathing for conventional roof areas.
- ✓ All wood windows and metal exterior doors.

General Specifications:

- ✓ Hybrid design.
- ✓ 3 bent, main timber frame structure.
- ✓ One storey plus loft over kitchen and dining area.
- ✓ 2 or 3 bedroom.
- ✓ Covered entry porch.

Regular Price; ~~\$88,250.00~~

On sale now; **\$79,425.00** USD plus shipping



THE TRILLIUM COLLECTION
Thistlewood Timber Frame Homes

Plan Number: BAY-01-2006



The Bayfield

1220 sq. Ft.

Floor Plans

Main Floor



Second Floor

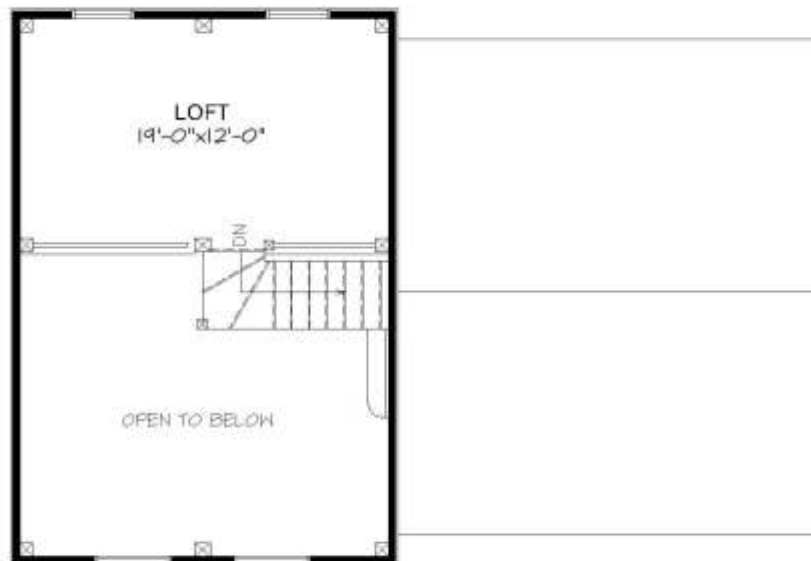

(Finished home not necessarily as shown.)